

SB500 SERIES

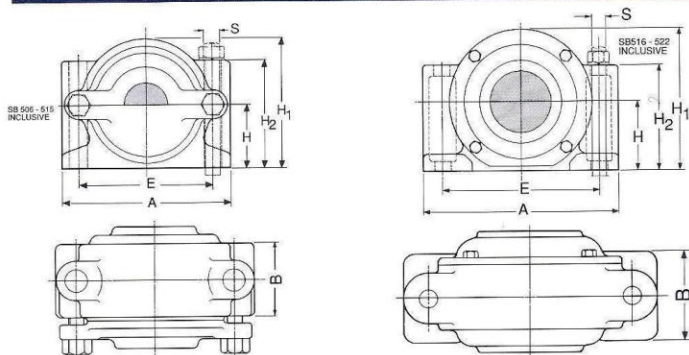

Basic Housing	Shaft dia. inch d	Housing Dimensions inch						
		A	B	E	H	H1	H2	L1
SB 506	1	4.25	1.63	3.25	1.5	3.06	2.69	-
SB 508	11/4	5	1.94	4	1.88	3.81	3.19	4.17
SB 509	11/2	5.25	1.88	4.25	2	4	3.25	4.33
SB 510	13/4	5.38	1.88	4.38	2.13	4.25	3.5	4.5
SB 511	2	6.25	2.13	4.88	2.31	4.69	3.88	5.25
SB 513	21/4	7.13	2.5	5.75	2.75	5.56	4.5	5.82
SB 515	21/2	7.5	2.5	6.13	3	6	4.75	5.9
SB 516	23/4	9.38	3.38	7.5	3.25	6.63	5	6.1
SB 517	3	10	3.5	8	3.5	7.13	5.38	6.4
SB 518	31/4	10.75	3.63	8.75	3.88	7.88	6	7.5
SB 520	31/2	11.75	4.06	9.5	4.25	8.63	7	7.9
SB 522	4	12.75	4.5	10.25	4.75	9.56	8	8.2

HOW TO ORDER

Order by quoting basic housing designation combined with required suffixes
Cast iron is standard. SG iron is available on request. Specify bearing number if fixing rings required.

SUFFIXES

A - closed cover
TA - V ring seals
TC - Felt seals
LS - Labyrinth Seals
LST - Taconite Seals

SB500 SERIES

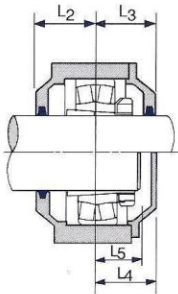

T.C.

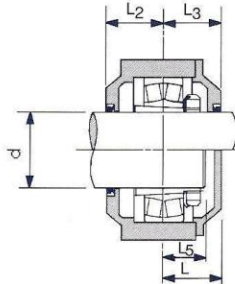

T.A.

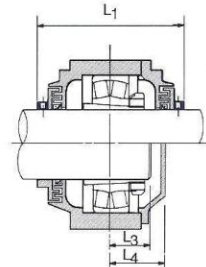

L.S.T

L2	L3	L4	L5	S	Approx. Weight (kg)	Basic Housing	Bearing with Adapter Sleeve Designation	Locating Ring	No.
1.25	1.56	1.38	0.88	1/2	1.5	SB 506	1206K + HE206 2206K + HE306	FR 7/62 FR 10/62	2 1
1.38	1.69	1.44	1.14	1/2	2.5	SB 508	1208K + HE208 2208K + HE308 22208K + HE308	FR 7.5/80 FR 10/80 FR 10/80	2 1 1
1.5	1.69	1.50	1.09	1/2	2.6	SB 509	1209K + HE209 2209K + HE309 22209K + HE309	FR 6/85 FR 8/85 FR 8/85	2 1 1
1.5	1.75	1.56	1.17	1/2	3	SB 510	1210K + HE210 2210K + HE310 22210 + HE310	FR 6.5/90 FR 10/90 FR 10/90	2 1 1
1.56	2	1.81	1.32	5/8	4.1	SB 511	1211K + HE211 2211K + HE311 22211K + HE311	FR 6/100 FR 8/100 FR 8/100	2 1 1
1.75	2.25	2.06	1.67	5/8	5.5	SB 513	1213K + HE213 2213K + HE313 22213K + HE313	FR 10/120 FR 12/120 FR 12/120	2 1 1
1.75	2.38	2.13	1.71	5/8	6.1	SB 515	1215K + HE215 2215K + HE315 22215K + HE315	FR 8/130 FR 10/130 FR 10/130	2 1 1
1.88	2.5	2.25	1.59	3/4	8.2	SB 516	1216K + HE216 2216K + HE316 22216K + HE316	FR 9/140 FR 11/140 FR 11/140	2 1 1
2.13	2.56	2.38	1.70	3/4	9.2	SB 517	1217K + HE217 2217K + HE317 22217K + HE317	FR 9/150 FR 10/150 FR 10/150	2 1 1
2.44	2.56	2.50	1.54	3/4	15.4	SB 518	1218K + HE218 2218K + HE318 22218K + HE318	FR 17.5/160 FR 12.5/160 FR 12.5/160	2 2 2
2.56	2.81	2.81	1.91	7/8	21.6	SB 520	1220K + HE220 2220K + HE320 22220K + HE320	FR 18/180 FR 12/180 FR 12/180	2 2 2
2.38	3.13	2.88	2.07	11/8	25.6	SB 522	1222K + HE222 2222K + HE322 22222K + HE322	FR 21/200 FR 13.5/200 FR 13.5/200	2 2 2

Dimensions L2, L3 apply to TA Type also. Dimension L1 applies to LS Type Also. The SB Series is the original imperial light duty standard. All dimensions in the table are in inches. It is possible to use this series for metric shafts also. For new designs it is preferable to use the Australian Standard WSB Series.